



**12 Brisbane Street Riverstone NSW**

4 2 2

This executive single-level 31 square Beechwood Home offers a wide frontage and boasts street appeal. This home is located on a 557m2 block and boasts all the amenities in today's modern homes.

Due to the large frontage, this can be an advantage to any buyer should future planning development amendments occur like in Schofields in 2021.

Some additional extras on offer include the low-maintenance fully fenced yard, enclosed entertainment area, and newly renovated kitchen.

Inclusions:

\* 4 bedrooms with built-in robes

[For full version visit the website](https://www.hometownpropertypartners.com.au)

**Type** : House  
**Price** : \$990,000-\$1,050,000  
**Building Size** : 292 sqm  
**Land Size** : 557 sqm  
**View** : <https://www.hometownpropertypartners.com.au/sale/nsw/western-sydney/riverstone/residential/house/8115796>



**Paula Pender**  
0499 699 542



# 12 Brisbane Road, Riverstone

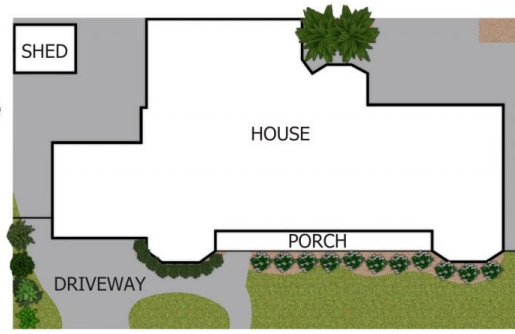

**SITE PLAN**

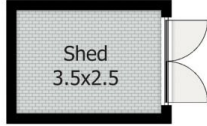

(NOT IN POSITION)



**FLOOR PLAN**

**DISCLAIMER:**

This floor plan is used for marketing purposes only and is not intended to be relied upon as a contract. It is subject to errors and omissions. The marketing Agent & N2 Marketing Pty Ltd accept no liability. Interested parties should make and rely on their own enquiries.

